

SHEET 1 OF 1

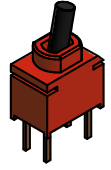

▲ SWITCH FUNCTION		
POS. 1	POS. 2	POS. 3
ON	NONE	OFF
4-6	N/A	OPEN

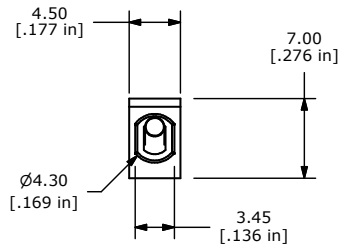
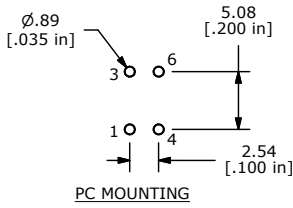
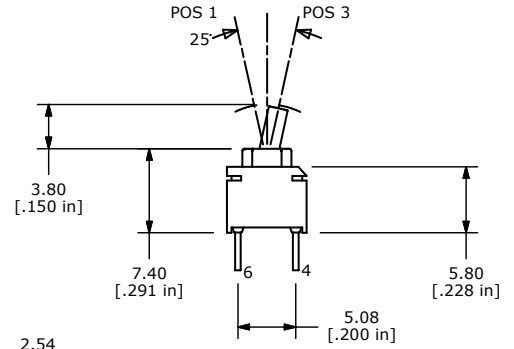
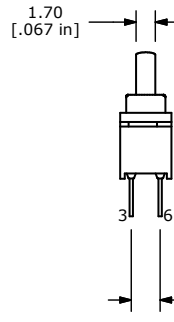
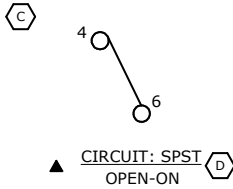

- NOTE:
- ALL DIMENSIONS IN MM [INCH]
 - GENERAL TOLERANCE: X.X=±0.4
X.XX=±0.25
 - TERMINAL NUMBERS FOR REF ONLY
 - ▲ 4. STATIONARY CONTACTS: COPPER ALLOY W/ GOLD PLATING
 - ▲ 5. MOVING CONTACT: COPPER ALLOY W/ GOLD PLATING
 6. RATING: 0.4 VA max. @ 20V AC OR DC max.
 7. CONTACT RESISTANCE: <100 MILLI-OHM
 8. MECHANICAL LIFE: 40,000 MAKE-AND-BREAK CYCLES.
 9. INSULATION RESISTANCE: 500 MEGA-OHM min.
 10. DIELECTRIC STRENGTH: 500 V RMS @SEA LEVEL.
 11. OPERATING TEMP.: -30°C to 85°C
 - ▲ 12. DENOTES CRITICAL PARAMETER.
 13. SEAL RATING: IP67
 14. 2002/95/EC (ROHS) COMPLIANT

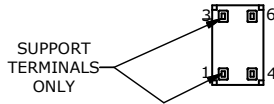

E	21332	REMOVE PACKAGING NOTE	12/17/13	EBP
D	19874	CORRECT TITLE OF SWITCH FUNCTION	04/25/11	BMA
C	19633	CORRECT SWITCH FUNCTION	01/31/11	BMA
B	19606	UPDATE PLATING NOTE	01/20/11	BMA
REV	PCR NO	DESCRIPTION	DATE	BY

THE INFORMATION CONTAINED IN THIS DOCUMENT IS PROPRIETARY TO E-SWITCH AND IS NOT TO BE COPIED OR TRANSFERRED



TITLE 200USP9T1A1M2RE

SCALE 2:1

DATE 12/2/2010

DR BMA

DWG T250008

REV E