

PANEL THICKNESS	X
0.75-1.25 [0.030-0.049]	19.2 [0.756]
1.25-2.0 [0.049-0.079]	19.4 [0.764]
2.0-3.0 [0.079-0.118]	19.8 [0.780]

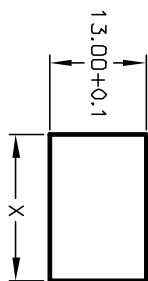

SWITCH FUNCTION	
POS. 1	POS. 2
DN	OFF
1-1a	OPEN

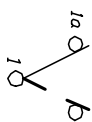

CIRCUIT: SPST

NOTES:

1. ALL DIMENSIONS IN MM [INCH]
2. GENERAL TOLERANCE: X.X=±0.4
X.XX=±0.25
3. TERMINAL NUMBERS FOR REF ONLY.
4. RATING: 15A @ 125VAC OR 6A @ 250VAC
5. MECHANICAL LIFE: 15,000 cycles
6. ELECTRICAL LIFE: 10,000 cycles
7. INSULATION RESISTANCE: >1000 Mega Ω
8. CONTACT RESISTANCE: <20 Mega Ω
9. DIELECTRIC STRENGTH: >1500 V 1 minute
>3000 V between poles

E-SWITCH®

R1966A BLK BLK F S

A	11664	RELEASED FOR PRODUCTION	9/19/01	CJB
REV.	ECN No.	DESCRIPTION	DATE	CHKD

TITLE		SCALE	DATE	DR	DWG	REV
R1966A BLK BLK F S		1.5:1	9/19/01	CB	M301207	A

THE INFORMATION CONTAINED IN THIS DOCUMENT IS PROPRIETARY TO E-SWITCH AND IS NOT TO BE COPIED OR TRANSMITTED