

4

3

2

1

THIS DRAWING IS UNPUBLISHED.		RELEASED FOR PUBLICATION		AUG. 2005.	
© COPYRIGHT 2005 BY TYCO ELECTRONICS CORPORATION.		ALL RIGHTS RESERVED.			

LOC	DIST	REVISIONS					
E	B	P	LTR	DESCRIPTION	DATE	DWN	APVD
		C		ECR-07-011430	14/05/07	AM	FWK

- NOTES:**
- ELECTRICAL DATA: CONTACT RESISTANCE: 10 mOhm MAX  
INSULATION RESISTANCE: 100 MOhm MIN at 500VDC  
CURRENT RATING: 5 AMPS  
BREAKDOWN VOLTAGE: 500 VAC MIN PER MINUTE
  - ENVIRONMENTAL: OPERATING TEMPERATURE: -25°C TO +90°C  
SEALING REQUIREMENTS: IP67
  - PROD SPEC: 108-3641
  - PACKAGING: 107-3334
  - FOR TECHNICAL DATA REFER TO YOUR LOCAL TYCO ELECTRONICS SALES OFFICE
  - ALL DIMENSIONS ARE NOMINAL FOR REFERENCE ONLY UNLESS OTHERWISE STATED

ITEM	DESCRIPTION	MATERIAL	FINISH/COLOUR	QTY
1	SCREW NUT	ZINC DIE CAST	2.5µm NICKEL PLATED	1
2	CONNECTOR BODY	POLYURETHANE	BLACK	1
3	PIN CONTACT	BRASS	0.15µm GOLD PLATED OVER NICKEL	3
4	3 CORE CABLE (CORES 0.34 mm <sup>2</sup> )	PU JACKET	BLACK	1

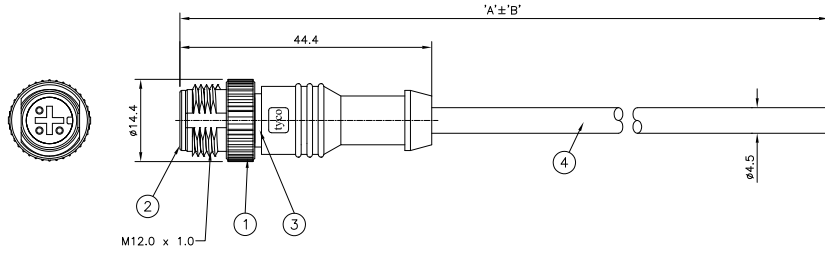
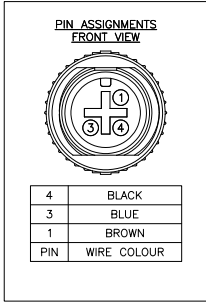

10000	500 mm	M12 STRAIGHT MALE CONNECTOR 10.0m CABLE	1838237-5
7000	350 mm	M12 STRAIGHT MALE CONNECTOR 7.0m CABLE	1838237-4
5000	250 mm	M12 STRAIGHT MALE CONNECTOR 5.0m CABLE	1838237-3
3000	150 mm	M12 STRAIGHT MALE CONNECTOR 3.0m CABLE	1838237-2
2000	100 mm	M12 STRAIGHT MALE CONNECTOR 2.0m CABLE	1838237-1
DIM A	TOL 'B'	DESCRIPTION	PART NUMBER

THIS DRAWING IS A CONTROLLED DOCUMENT.		DWN	22AUG05	Tyco Electronics Corporation	
		H M RAGHAVENDRA		Bideford, UK, EX39 4HE	
		CHK	07AUG06	Tyco Electronics	
		F.WHEELER-KING		M12 STRAIGHT MALE CONNECTOR	
		APVD	07AUG06	3 POSITION, PU CABLE	
		F.WHEELER-KING		RESTRICTED TO	
		PRODUCT SPEC		-	
		APPLICATION SPEC		-	
		WEIGHT		-	
		CUSTOMER DRAWING		-	
DIMENSIONS: mm		TOLERANCES UNLESS OTHERWISE SPECIFIED:		SIZE	CAGE CODE
0 PLC ±		0.15		A3	00779
1 PLC ±		0.25		DRAWING NO	
2 PLC ±		0.30		C=1838237	
3 PLC ±		0.40		SCALE	
4 PLC ±		0.50		NTS	
ANGLES ±		0.15		SHEET 1 OF 1	
MATERIAL		FINISH		REV C	