

4

3

2

1

THIS DRAWING IS UNPUBLISHED.		RELEASED FOR PUBLICATION		LOC		DIST		REVISIONS											
© COPYRIGHT - By -		ALL RIGHTS RESERVED.		E		B		P		LTR		DESCRIPTION		DATE		DWN		APVD	
								C1		REVISED PER ECO-11-005150		21MAR11		RK		HMR			

- NOTES:
- ELECTRICAL DATA: CONTACT RESISTANCE: 10 mOhm MAX
INSULATION RESISTANCE: 100 MOhm MIN at 500VDC
CURRENT RATING: 5 AMPS
BREAKDOWN VOLTAGE: 500 VAC MIN PER MINUTE
 - ENVIRONMENTAL: OPERATING TEMPERATURE: -20°C TO +80°C
SEALING REQUIREMENTS: IP67
 - PROD SPEC: 108-3641
 - PACKAGING: 107-3334
 - FOR TECHNICAL DATA REFER TO YOUR LOCAL TE CONNECTIVITY SALES OFFICE
 - ALL DIMENSIONS ARE NOMINAL FOR REFERENCE ONLY UNLESS OTHERWISE STATED

ITEM	DESCRIPTION	MATERIAL	FINISH/COLOUR	QTY
1	SCREW NUT	ZINC DIE CAST	2.5µm NICKEL PLATED	1
2	CONNECTOR BODY	POLYURETHANE	BLACK	1
3	PIN CONTACT	BRASS	0.15µm GOLD PLATED OVER NICKEL	3
4	3 CORE CABLE (CORES 22AWG TO UL2464)	PVC JACKET UV RESISTANT	BLACK	1

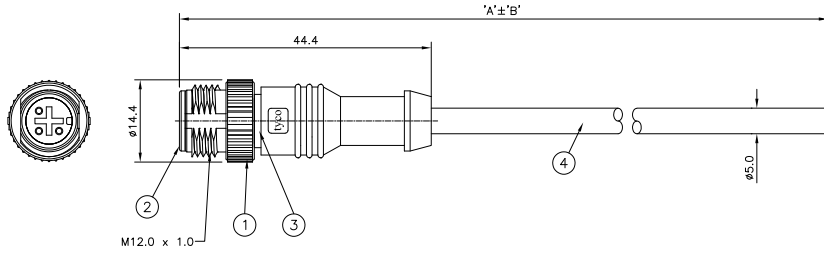
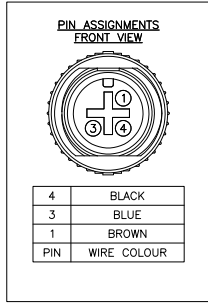

10000	500mm	M12 STRAIGHT MALE CONNECTOR 10.0m CABLE	1838236-5
7000	350mm	M12 STRAIGHT MALE CONNECTOR 7.0m CABLE	1838236-4
5000	250mm	M12 STRAIGHT MALE CONNECTOR 5.0m CABLE	1838236-3
3000	150mm	M12 STRAIGHT MALE CONNECTOR 3.0m CABLE	1838236-2
2000	100mm	M12 STRAIGHT MALE CONNECTOR 2.0m CABLE	1838236-1
DIM A TOL 'B'			DESCRIPTION
			PART NUMBER

THIS DRAWING IS A CONTROLLED DOCUMENT.		DWN 19AUG05 H M RAGHAVENDRA		STE TE Connectivity	
DIMENSIONS: mm		CHK 15DEC05 F.WHEELER-KING			
TOLERANCES UNLESS OTHERWISE SPECIFIED:		APVD 15DEC05 F.WHEELER-KING		NAME	
0 PLC ±		PRODUCT SPEC		M12 STRAIGHT MALE CONNECTOR	
1 PLC ±		APPLICATION SPEC		3 POSITION, PVC CABLE	
2 PLC ±		WEIGHT		SIZE CAGE CODE DRAWING NO	
3 PLC ±		CUSTOMER DRAWING		A3 00779 C=1838236	
4 PLC ±		SCALE		RESTRICTED TO	
ANGLES ±		NTS		SHEET 1 of 1	
FINISH		REV		C1	